

4

3

2

1

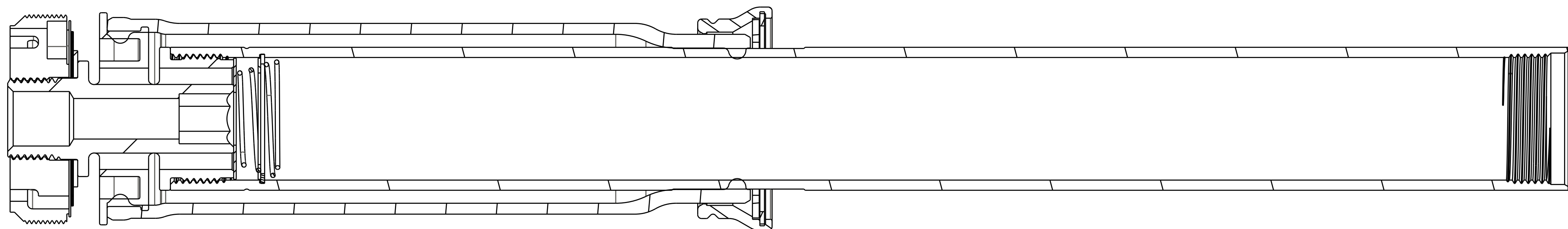

038-00-065
Retaining Ring: Snap, Smalley, Internal, Custom, Ø.923 BORE

241-01-029
Bladder retainer, 011 RC2

210-22-609
LOWER BLADDER RING, SNAP RING, 013 32-34 CTD F/P AND iRD CD

210-22-303
Bladder, 010 RL.RLC

! IMPORTANT:
ENSURE RETAINING RING IS FULLY
SEATED INTO GROOVE FULL 360°

045-00-130
VALVE, 14.12MM OD X 6.15MM ID X 0.3MM TH

039-00-205
Spring, Comp. Check, 2013 FIT-CTD, FIT-CTD Adjust and iCD

! IMPORTANT:
ENSURE RETAINING RING IS FULLY
SEATED INTO GROOVE FULL 360°

GREASE:
THIN LAYER
OF SLICK HONEY
ON INNER/OUTER
SURFACES

820-03-341-KIT
COMPRESSION VALVE STACK

TORQUE:
75±5 IN.LB.

210-22-303
CARTRIDGE BODY

038-00-061
Retaining Ring: Internal, Smalley VH-56, 302 Stainless Steel

045-00-131
VALVE, METRIC [14.12MM OD X 10.67MM ID X 0.30MM TH]

FOX FOX Factory, Inc. Ph 831-768-1100
130 Hangar Way, Watsonville, CA 95076 USA Fax 831-768-9312

TITLE
**2015 32/34 FIT CTD
Bladder and Cart Body**

SIZE DWG. NO.
C
PLOT SCALE | .00:1 | SHEET 1 OF 1

- PROPRIETARY -
THIS DOCUMENT CONTAINS CONFIDENTIAL, PROPRIETARY INFORMATION
THAT IS FOX PROPERTY. DO NOT DISCLOSE TO OR DUPLICATE
FOR OTHERS EXCEPT AS AUTHORIZED BY FOX.

4

3

2

ProE ASSEM